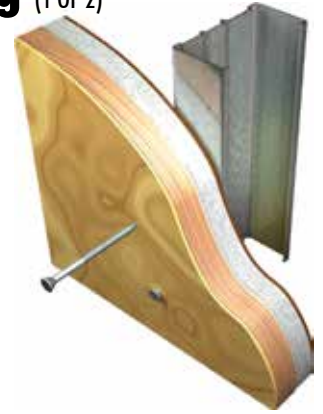

Stainless Steel**Product #214SS****Trim Head 304 Stainless Steel STREAKER® Self tapping** (1 OF 2)**Self tapping screw for attaching wood trim over single or double-layer gypsum board to steel.****Finish - 304 Stainless Steel**Trim
Head23° Streaker®
Point#1 Square
Drive**APPLICATIONS**

- ▶ Wood trim over single and double-layer gypsum board to 25-20 gauge steel studs and track
- ▶ Wood trim over single and double-layer gypsum board to wood studs

PRODUCT FEATURES

- ▶ A fine thread screw for finishing applications
- ▶ Trim to Steel or Wood framing
- ▶ Non- Magnetic
- ▶ 15 threads per inch for wood or metal
- ▶ #1 square recess drive

SPECIFICATIONS

- ▶ Gauge – #7 and #8
- ▶ Lengths – 1-5/8" to 3"
- ▶ Head Type – Trim
- ▶ Recess Type – #1 Square
- ▶ Thread Type – Double Lead
- ▶ Finish – 304 Stainless Steel
- ▶ GRABBER® screws are manufactured in an ISO 9002 and ISO 14001 certified and approved factory.

INSTALLATION GUIDELINES

- ▶ Use a standard screwgun with a depth-sensitive nose piece. Suggested screwgun specification for optimal performance – 4 amps minimum and RPM range of 0 to 4,000.
- ▶ The Trim head is fully seated when the head is flush with the work surface.
- ▶ Overdriving may result in failure of the fastener or stripout of the work surface.
- ▶ The fastener must penetrate beyond the metal a minimum of three thread pitches.

Stainless Steel

Product #214SS

Trim Head 304 Stainless Steel STREAKER® Self tapping (2 OF 2)

PRODUCT SIZES AND ORDERING INFORMATION

Catalog No.	Gauge/Length	Length Metric	Quantity Per Carton	Weight Per Carton
17SSQ	#7x1-5/8"	41 mm	10 M	49.00(lbs)
18SSQ	#7x2-1/4"	57 mm	5 M	34.00(lbs)
17S76SSQ	#8x3"	76 mm	2 M	22.00(lbs)

PRODUCT DIMENSIONS (MILLIMETERS)

Gauge	B Head Dia	Recess Depth	W Gauging Width	d Shank Dia	d1 Minor Dia	d2 Major Dia	TPI
#7	5.30	1.20	#1	2.93	2.40	3.75	15
	5.80	1.50		2.97	2.55	3.90	
#8	5.30	1.20	#1	3.18	2.80	4.00	15
	5.80	1.50		3.22	3.00	4.20	

Pull-out Test Data**

Gauge	2x2 Douglas	2x4 Redwood	1x3 Clear Pine	1" Plywood	3/4" Particleboard
#7	428	337	322	197	235
#8	428	515	341	274	242

**GRABBER fasteners are not categorized as structural bolts. The figures listed above are ultimate average values achieved under independent laboratory conditions, and apply to GRABBER Line fasteners only. An appropriate safety factor must be determined by a qualified professional for design purposes.

STANDARD CORROSION TEST RESULTS

Finish	Test	Standard/Protocol	Results
304 Stainless Steel	Salt Spray Results	ASTM B117	1,000 hours, no red rust

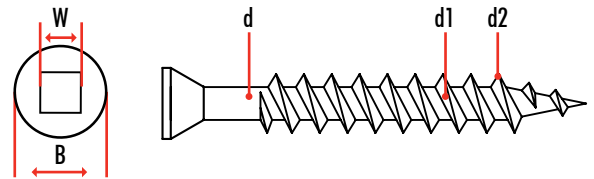

All GRABBER® screw products are manufactured in facilities that are ISO 9002 and ISO 14001 certified and approved.

