

EXTERIOR WOOD

Product #214

Trim Head STREAKER® (1 OF 2)

Fine thread, trim head screw for attaching wood trim over single or double-layer gypsum board to steel

Finish - GRABBERGARD®

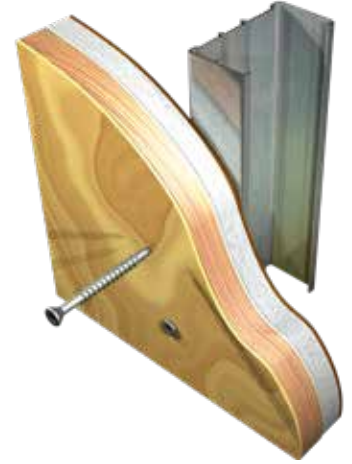
Trim
Head23° Streaker®
Point#1 Square
Drive**APPLICATIONS**

- ▶ Wood trim over single and double-layer gypsum board to 20 to 25 gauge steel studs and track
- ▶ Wood trim over single and double-layer gypsum board to wood studs

PRODUCT FEATURES

- ▶ A fine thread screw for finishing applications 15 threads per inch
- ▶ Super sharp, 23° STREAKER® point, designed to penetrate steel quickly and easily
- ▶ #1 square recess drive

SPECIFICATIONS

- ▶ Gauge - #7 and #8
- ▶ Lengths - 1-5/8" to 3"
- ▶ Head Type - Trim
- ▶ Recess Type - #1 square
- ▶ Thread Type - Double Lead
- ▶ Finish - Gray Phosphate, Clear Zinc, GRABBERGARD®
- ▶ GRABBER® screws are manufactured in an ISO 9001 and ISO 14001 certified and approved factory.

INSTALLATION GUIDELINES

- ▶ Use a standard screwgun with a depth-sensitive nose piece. Suggested screwgun specification for optimal performance - 4 amps minimum and 2500 RPM.
- ▶ The Trim head is fully seated when the head is flush with the work surface.
- ▶ Overdriving may result in failure of the fastener or stripout of the work surface.
- ▶ The fastener must penetrate beyond the metal a minimum of three thread pitches.

EXTERIOR WOOD

Product #214

Trim Head STREAKER® (2 OF 2)

PRODUCT SIZES AND ORDERING INFORMATION

Catalog No.	Gauge/Length	Length Metric	Quantity Per Carton	Weight Per Carton
17SRG	#7x1-5/8"	41 mm	10 M	49.00(lbs)
18SRG	#7x2-1/4"	57 mm	5 M	34.00(lbs)
17S76RG	#8x3"	76 mm	2 M	22.00(lbs)

*1lb Box and 5lb Box screw packaging option available on selected items.

PRODUCT DIMENSIONS (MILLIMETERS)

Gauge	B Head Dia	Recess Depth	W Gauging Width	d Shank Dia	d1 Minor Dia	d2 Major Dia	TPI
#7	5.30	1.20	#1	2.93	2.40	3.75	15
	5.80	1.50		2.97	2.55	3.90	
#8	5.30	1.20	#1	3.18	2.80	4.00	15
	5.80	1.50		3.22	3.00	4.20	

PULL-OUT TEST DATA

Screw Gauge	Metal Gauge	Tension (lbs.)	Shear (lbs.)
#7	20	222	817
	25	100	245
#8	20	342	785
	25	145	325

SHEET STEEL GAUGES

Gauge No.	Decimal Equivalent	Millimeter Equivalent
20	0.0396"	1 mm
25	0.0188"	.6 mm

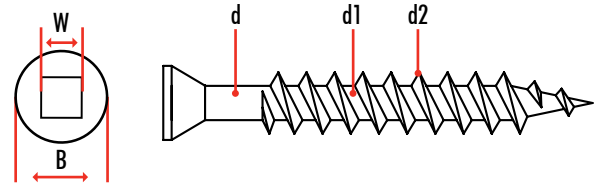

All GRABBER® screw products are manufactured in facilities that are ISO 9001 certified. ©2012 GRABBER Construction Products, Inc. GRABBER®, STREAKER®, DRIVALL®, LOX®, GRABBERGARD® and SCAVENGER® are registered trademarks of Grabber Construction Products, Inc.

