

# Cement-Coated Drywall Nails

## Drywall to Wood

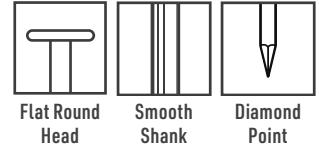
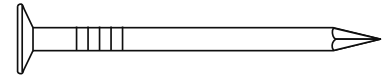
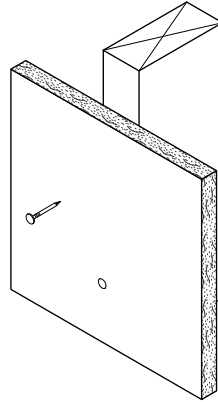
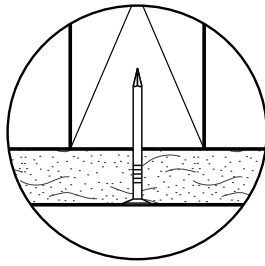

**Description** Attaches gypsum board to wood.

**Specifications**

**Size | Gauge:** 12.5 and 13  
**Length:** 1 1/4 in. to 2 3/8 in.  
**Head Type:** Flat Round  
**Shank Type:** Smooth  
**Finish:** Cement

**Quality Assurance:** Grabber® fasteners are manufactured in ISO 9001 and ISO 14001 certified and approved factories.  
**LEED Reporting:** The post-consumer recycled steel content is 25%.  
**Compliance:** The fasteners comply with ASTM F1667 performance requirements.

**Applications**

- 3/8 in., 1/2 in., and 5/8 in. single-layer gypsum board to wood studs
- 1/2 in. and 5/8 in. double-layer gypsum board to wood

**Installation**

- The head is fully seated when it's just below the surface of the gypsum board.

**Features**

- Flat round head provides a large area to hold the gypsum board securely.
- Smooth shank penetrates the wood easily and smoothly.
- Long, diamond-shaped point is designed to easily drive into wood, and it helps prevent splitting.
- Cement coating helps drywall compound adhere better to the nail head.

# Cement-Coated Drywall Nails

## Drywall to Wood

**GRABBER**  
CONSTRUCTION PRODUCTS

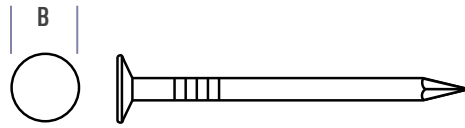

Product  
Dimensions

Nail Gauge	B Head Diameter	Wire Diameter
12.5	0.3438 in.	0.099 in.
13	0.3750 in.	0.091 in.

### Ordering Information and Product Options

Item No.	Size	Head Type	Head Diameter	Gauge	Shank Type	Quantity	Weight	Special Features
<b>Cement</b>								
DWCC125H	1 1/4 in.	Flat Round	0.3438 in.	12.5	Smooth	16,250	50 lb.	
DWCC138	1 3/8 in.	Flat Round	0.3750 in.	13	Smooth	17,000	50 lb.	
DWCC138125G	1 3/8 in.	Flat Round	0.3750 in.	12.5	Smooth	15,750	50 lb.	
DWCC150	1 1/2 in.	Flat Round	0.3750 in.	13	Smooth	16,000	50 lb.	
DWCC178	1 7/8 in.	Flat Round	0.3750 in.	13	Smooth	13,000	50 lb.	
DWCC200	2 in.	Flat Round	0.3750 in.	13	Smooth	12,000	50 lb.	
DWCC200125G	2 in.	Flat Round	0.3750 in.	12.5	Smooth	10,000	50 lb.	
DWCC238	2 3/8 in.	Flat Round	0.3750 in.	13	Smooth	10,000	50 lb.	

Note: Product availability is subject to change without prior notice, and the availability of products may differ from what is printed in literature and displayed on our website. The items listed are bulk size. Most are also available in smaller package sizes such as 5 lb. and 1 lb. Contact your local Grabber Branch or GrabberPro for more information.

Cement-Coated Drywall Nails  
PS1063 USA-ENG/Rev. 02-25

GRABBER CONSTRUCTION PRODUCTS, INC.  
5255 W 11000 N., STE 100  
HIGHLAND, UT 84003

(800) 477-8876 | GrabberPro.com

**SAFETY FIRST:** Wear appropriate personal protective equipment. Read applicable SDS and literature before handling and installation.

**TECHNICAL INFORMATION:** Technical information contained herein is furnished without charge or obligation and is given and accepted at the recipient's sole risk. Because conditions of use may vary and are beyond our control, Grabber Construction Products makes no representation about, and is not responsible or liable for, the accuracy or reliability of data associated with uses of any product described herein. Grabber Construction Products reserves the right to modify this document without prior notice.

© 2025 Grabber Construction Products, Inc. | All rights reserved | Printed in U.S.A.  
The trademarks Grabber, and Stylized G on Grabber Fasteners, are trademarks of Grabber Construction Products, Inc.

