

Flat Wafer Head, Hi-Lo Thread, Streaker® - Exterior

Plywood, Cement Board to Light-Gauge Steel or Wood

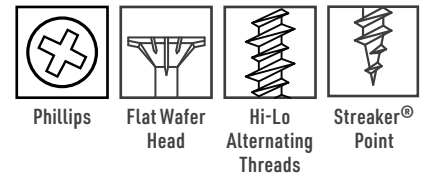
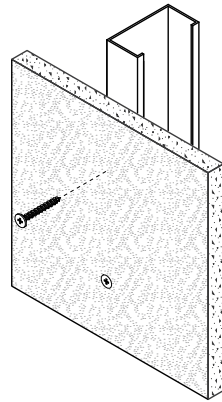
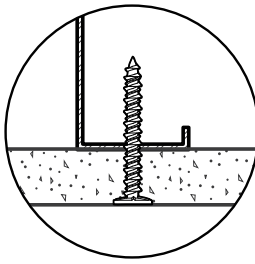

Description Attaches high-density sheathing to light-gauge steel or wood.

Specifications

Size | Gauge: #8 and #10
Length: 1 1/4 in. to 3 1/2 in.
Head Type: Flat Wafer Head
Recess Type: #2 Phillips
Thread Type: Hi-Lo Alternating
Finish: GrabberGard® 1500

Quality Assurance: Grabber® fasteners are manufactured in ISO 9001 and ISO 14001 certified and approved factories.
LEED Reporting: The post-consumer recycled steel content is 25%.
Compliance: ASTM C1513.

- Applications**
- Cement board to light-gauge steel or wood
 - High-density board to light-gauge steel or wood
 - Tile backers to light-gauge steel or wood

- Installation**
- Use a standard screw gun with a depth-sensitive nose piece. Suggested screw gun specification for optimal performance: sizes #8 and #10, up to 4,000 RPM.
 - The screw head is fully seated when it is flush with the surface of the material.
 - The fastener must penetrate beyond the steel three full thread pitches.
 - The fastener should penetrate the wood at least 3/4 in., in accordance with AWC-NDS for wood construction.
 - Overdriving may result in failure of the fastener.

- Features**
- Grabber's #2 Phillips recess is a precision recess designed for better bit engagement, resulting in less wobble or strip-out.
 - This wafer head design provides for a larger load-bearing surface and better holding power.
 - Underhead nibs facilitate seating and minimize strip-out.
 - Alternating Hi-Lo threads provide stronger holding in wood or steel.
 - GrabberGard® exterior-grade coating provides additional protection against corrosion in most exterior applications.

Flat Wafer Head, Hi-Lo Thread, Streaker® - Exterior

Plywood, Cement Board to Light-Gauge Steel or Wood



Standard Corrosion Test Results

Finish	Test	Standard/Protocol	Results
GrabberGard® 1500	Salt Spray	ASTM B117	1,500 hrs., no red rust

Note: Salt Spray Testing (SST) results are not intended to predict corrosion in real-world environments. The ASTM B117 standard for SST is recognized industry-wide as an effective tool for comparing different metals and different metal coatings in a tightly controlled, highly corrosive environment for specific periods of time. For more information about corrosion resistance, see the Grabber Guide to Corrosion Resistance for Fasteners.

Pull-Out Test Data¹

Screw Gauge	TPI ²	Steel Gauge	Design Thickness	Tension	Shear
#8	15 Hi-Lo	25	0.0188 in.	39 lbs.	66 lbs.
		20	0.0346 in.	72 lbs.	164 lbs.
#10	15 Hi-Lo	25	0.0188 in.	46 lbs.	71 lbs.
		20	0.0346 in.	84 lbs.	177 lbs.

¹Test data values reported are allowable as determined by calculations and industry established test criteria, such as ICC-ES Acceptance Criteria and ASTM test standards. Please contact Grabber for detailed information about testing performed for specific products or if ultimate values are needed.

Sheet Steel Gauges

Gauge No.	Design Thickness	Millimeter Equivalent
25	0.0188 in.	0.4775 mm
20	0.0346 in.	0.8788 mm

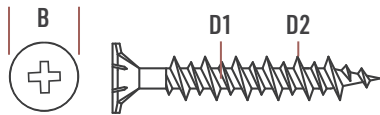

Product Dimensions

Screw Size	B Head Diameter	Recess	D1 Hi Thread Major Diameter	D2 Lo Thread Major Diameter	TPI ²
#8	0.404 in.	#2 Phillips	0.142 in.	0.177 in.	15 Hi-Lo
#10	0.404 in.	#2 Phillips	0.161 in.	0.195 in.	14 Hi-Lo

²TPI stands for Threads Per Inch. This is a count of the number of threads per inch measured along the length of a fastener.

Ordering Information and Product Options

Item No.	Size	Recess	Head Diameter	TPI	Quantity	Weight	Special Features
GrabberGard® Gray							
GCB8125HL	8 X 1 1/4 IN.	#2 Phillips	0.404 in.	15 Hi-Lo	5,000	25 lb.	Underhead nibs
GCB8158HL	8 x 1 5/8 in.	#2 Phillips	0.404 in.	15 Hi-Lo	4,000	29 lb.	
GCB8238HL	8 x 2 3/8 in.	#2 Phillips	0.404 in.	15 Hi-Lo	3,000	30 lb.	
GCB10350HL	10 x 3 1/2 in.	#2 Phillips	0.404 in.	15 Hi-Lo	1,000	20 lb.	
CGCB8125HL	8 x 1 1/4 in.	#2 Phillips	0.404 in.	15 Hi-Lo	1,000	5 lb.	Collated, Underhead nibs

Note: Product availability is subject to change without prior notice and the availability of products may differ from what is printed in literature and displayed on our website. The items listed are bulk size. Most are also available in smaller package sizes such as 5 lb. and 1 lb. Contact your local Grabber Branch or GrabberPro for more information.

Flat Wafer Head, Hi-Lo Thread, Streaker® - Exterior
 PS1036 USA-ENG/Rev. 05-25
GRABBER CONSTRUCTION PRODUCTS, INC.
 5255 W 11000 N., STE 100
 HIGHLAND, UT 84003
 (800) 477-8876 | GrabberPro.com

SAFETY FIRST: Wear appropriate personal protective equipment. Read applicable SDS and literature before handling and installation.

TECHNICAL INFORMATION: Technical information contained herein is furnished without charge or obligation and is given and accepted at the recipient's sole risk. Because conditions of use may vary and are beyond our control, Grabber Construction Products makes no representation about, and is not responsible or liable for, the accuracy or reliability of data associated with uses of any product described herein. Grabber Construction Products reserves the right to modify this document without prior notice.

© 2025 Grabber Construction Products, Inc. | All rights reserved | Printed in U.S.A.
 The trademarks Grabber, GrabberGard, Streaker, and Stylized G on Grabber Fasteners, are trademarks of Grabber Construction Products, Inc.

